

Ground floor plan

New walls to cupboards and toilets

Timber stud walls to be formed with structural grade softwood studs 75x50mm, and 2 layers of 12.5mm plasterboard and skim coat. Walls filled with Rockwool acoustic quilting. New timbers to be separated from existing walls with strips of damp proof membrane. Perimeter of new walls to be sealed with acoustic sealant.

Ceilings

Ceilings above the toilets 2 layers of 12.5mm plasterboard and skim coat fixed to 100x50mm joists hung on galvanised metal jist hangers. Line joists with WBP plywood for high level cupboards.

Structural alterations

The new mezzanine is to be supported on beams B1 - B3 using structural timber combined with steel fitch plates. Beam B4 to support the adapted staircase leading up to the Ringing Chamber.

New staircase and mezzanine

Contractor to survey ground floor of the tower once existing fittings and fixtures are removed to check all dimensions before arranging for joinery workshop drawings to be prepared by the joinery sub-contractor for comments and acceptance.

New stair to be formed in oak to stair treads, risers, newels, balusters and handrails. Stair treads to be 250mm and risers 192mm subject to confirmation by the contractor. Clear width between handrails to be no less than 800mm. Height of balustrading/handrails to rise of stair 900 above nosings and 1100mm above finish levels of the landing and mezzanine deck.

Doors D3 - D7

All new doors to toilets and cupboards to be solid core oak veneered faces with oak tipping, linings, stops and architraves. Additionally, all cupboard doors and cupboard doors above the toilet ceilings to be fire rated and certified FD30S doors complete with smoke seals, intumescent strips, and intumescent linings to hinges, lock and latch cases.

Doors D1 Existing lower entrance doors

Doors D2 new bespoke glazed doors

Doors D8 Existing glass doors to be relocated and fitted with automatic closing devices.

Doors D9, D10, D11 and high level cupboard doors to be solid core paint quality doors and fire rated FD30S complete with smoke seals, intumescent strips, and intumescent linings to hinges, lock and latch cases.

Flooring

New toilets to have anti-slip vinyl flooring laid on 22mm WBP plywood fixed to 18mm battens laid in strips of damp proof membrane. Turn membrane up where batten ends sit against the external walls. Set battens 25mm away from wall where running parallel. Include for chamfered hardwood threshold across the entrance to the toilets as shown on the plan.

Allow for repairs to the stone flooring where effected by the removal of the clock weights enclosure and the existing timber entrance lobby screen and floor pivots. Allow to peice in sections of Horsham stone if suitable stone available or York stone. If several small pieces are required allow to lift and relay with larger replacement sections of stone.

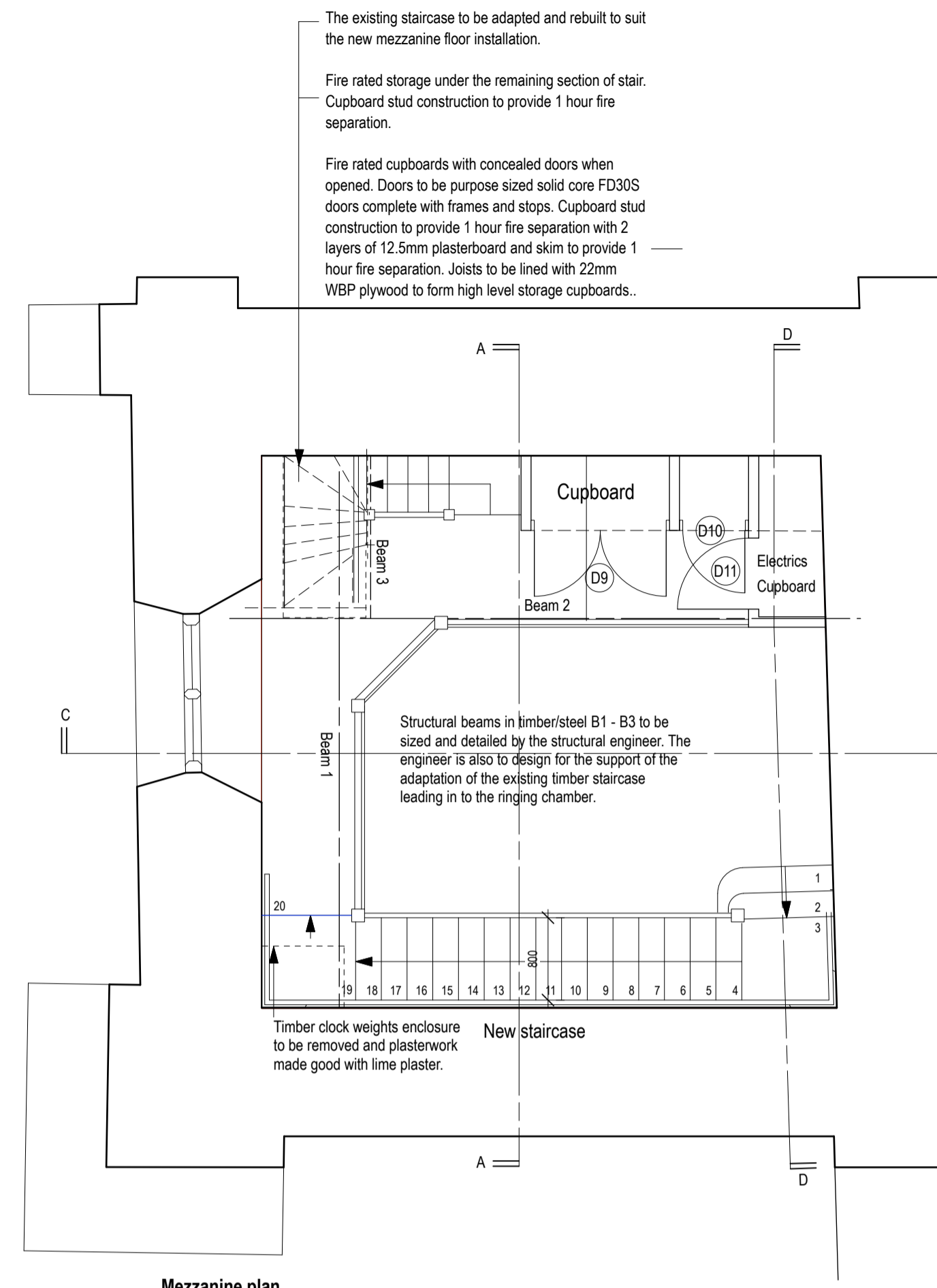

Mezzanine plan

Mezzanine deck

Floor deck 22mm engineered oak boards on 150mm joists on hangers at 400mm centres. 25mm plasterboard and skim to provide 1 hour fire separation.

Treads to the new staircase to be in Oak and to have two rows of anti-slip stripes rebated in to the tread.

Solid oak hand rails, newel posts and balusters.

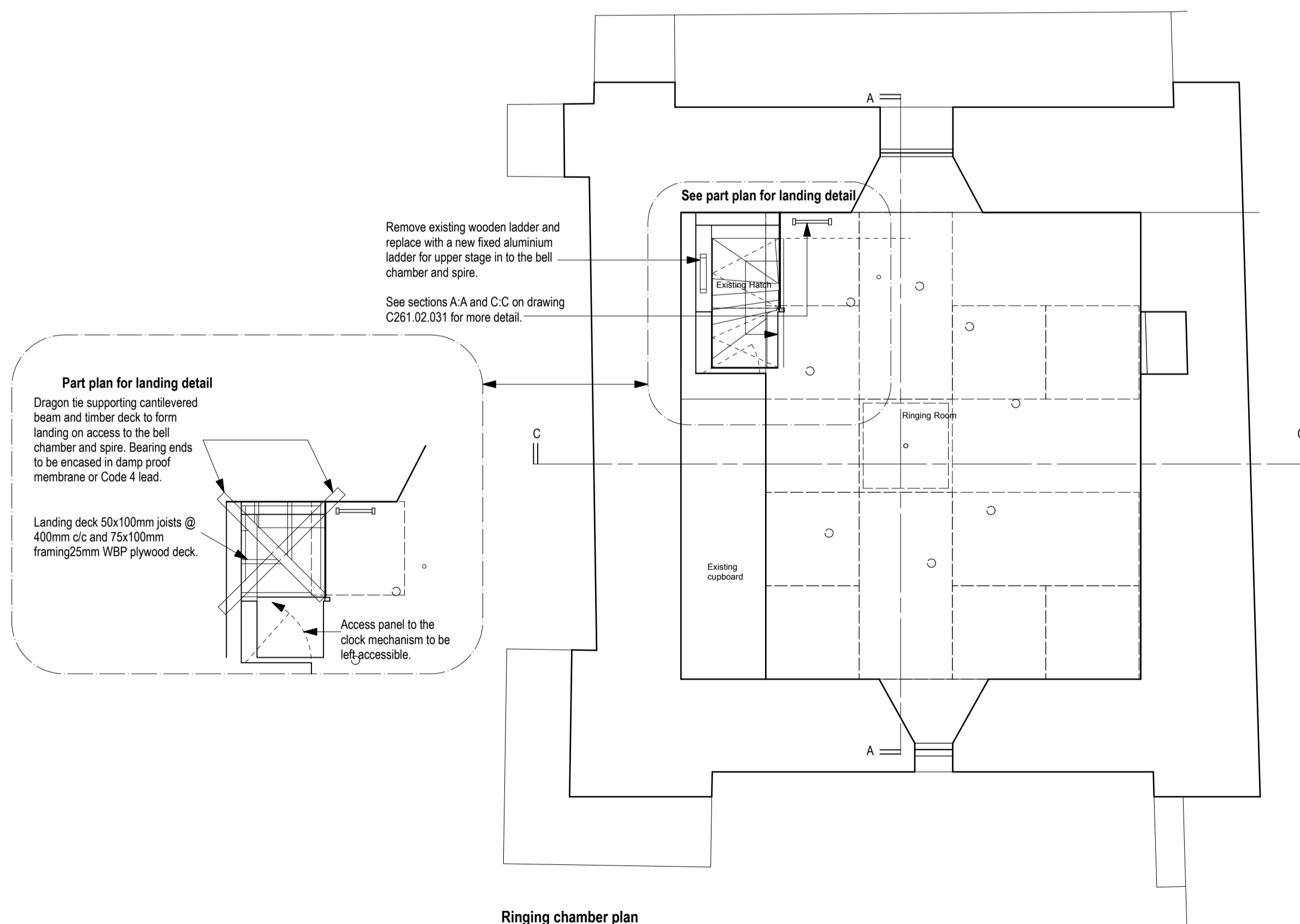

Ringing chamber plan

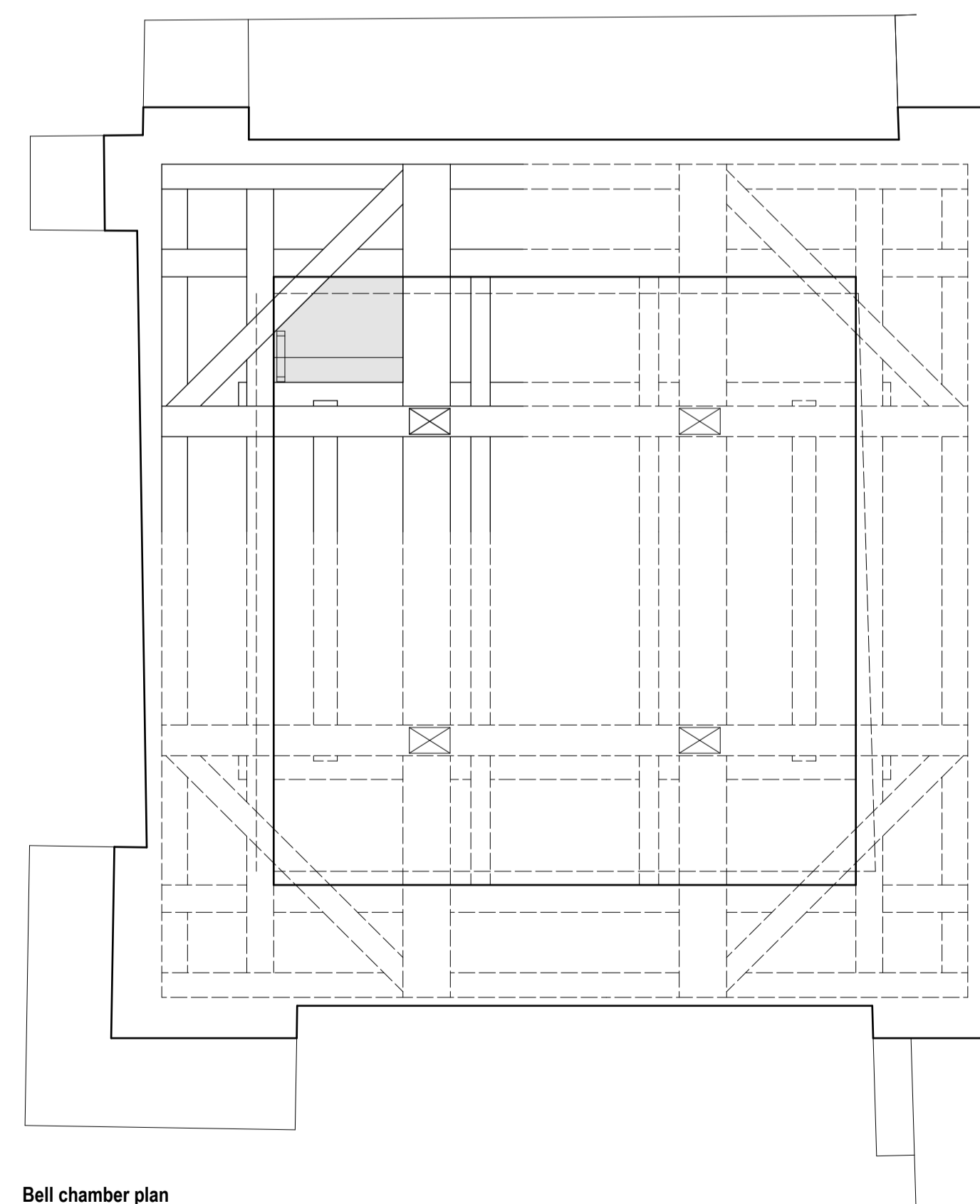

Bell chamber plan

Rev C: Additional fire protection notes for fire collars and stopping added to the drawing 16.06.2020

Rev B: Corrections to plasterboard thickness and fold out aluminium ladder in the ringing chamber changed to a fixed ladder. 01.06.2020

Rev A: Revised arrangement of stairs and treads to ground floor stair to mezzanine level, adaptation of the upper section of the existing lower staircase to suit new mezzanine level, and new access arrangements from the ringing chamber to the bell chamber. 13.05.2020

hmdw architects ltd

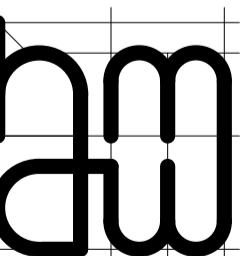

The Old Church
Whyke Road, Chichester
tel: 01243 830 322
fax: 01243 788 024
chichester@hmdw-architects.co.uk
www.hmdw-architects.co.uk

Project
ST. MARY'S CHURCH, BILLINGSHURST

Drawing
ALTERATIONS TO THE CHURCH TOWER TO
INSTALL NEW STAIRS AND MEZZANINE
ACCESS TO THE RINGING CHAMBER.

Scale Date
1:50 07.04.2020

Job No. - Drg. No. Revision Drawn Checked
C261.02.030 Rev C SD